



Smart Wi-Fi AC Switch

Installation and User Manual



Please make sure to turn off the main power switch before installation.

Contents

1. After-sale service & Warm tips
2. Caution
3. Product information
4. Install the Smart AC Switch
5. Download & Install the App
6. Add new device
7. How to connect the Smart AC Switch to Alexa
8. How to control the Smart AC Switch with Siri
9. How to change WiFi from 5.0 to 2.4 Hz
10. Troubleshooting Tips

1. After-sale service & Warm tips

If you cannot connect with the quick flash mode (light flashevery 1 second), please use the AP mode slow flash (light flash every 3 seconds) to connect with the Switch.

This Smart AC Switch is provided with one-year after-sale service since the date of purchasing.

If you have any questions while operating the product or the Switch is defective, or the Switch cannot connect with the WiFi, please feel free to contact the service mail. We will help you solve the problems and we can send you free replacement.

Tips

1.1 This Smart AC Switch can only support 2.4G network & cannot work with 5.0G network. Please check if your home network is 2.4G and make sure that your phone has been connected to your home Wi-Fi network.

2. Caution

- 2.1 Cut the power before installing so as to protect yourself from electric shock.
- 2.2 Please ensure that the neutral and live wires are installed correctly.
- 2.3 Please pay attention to tighten the screws and wires.

3. Product Information

3.1 Features

- Touch Control: On/Off
- App Control: On/Off
- RF433 remote (Optional)
- Scheduled / Timer / Shares
- Works with Amazon Alexa
- Works with Amazon Siri
- Works with Google Home
- Works with IFTTT

3.2 Specification

- Power Supply: 95V-250V AC
- Max. Current: 40A
- Max. Power: 2200W/gang
- Wireless: 802.11 b/g/n 2.4G
- Security: WPA-PSK/WPA2-PSK
- Material: ABS + Tempered Glass
- Size: 86x86x32mm, EU/UK plug
- Size: 120x76x32mm, US plug

Certification: CE, RoHS, FCC

4. Install the Smart AC Switch

This Smart AC Switch can't work without Neutral Line, make sure have N line connection.

Please cut off the power when doing the installation & un-installation

- 4.1 Open the Switch glass panel by screw from the frame hole.
- 4.2 Connect the wiring as wiring diagram.
- 4.3 Tighten the screw into the wall mount.
- 4.4 Click back the touch panel into place.
- 4.5 Connect the power supply after finishing the installation steps.

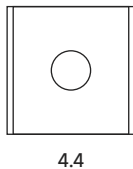
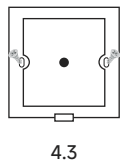
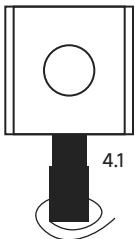

Wiring Diagram N & L version

1. Live connect to 'L' terminal
2. Neutral connect to 'N'
3. Lamp Live connect to L1 L2 L3 terminal

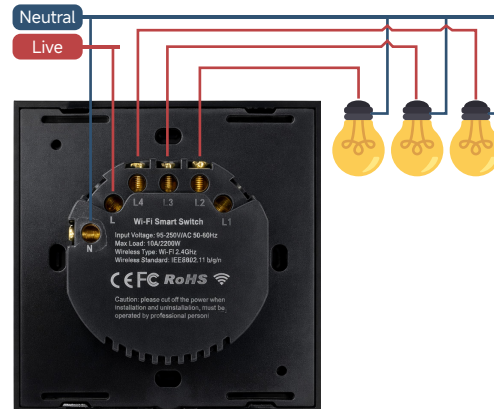

5. Download & Install the APP

5.1 Go to your App Store & search the "Smart Life" & install the app.

5.2 Input account name and password to login. If you don't have an account, please register an account first. System will identify your country automatically. You can use your mobile phone number as your account name.

5.3 Tap on "Next" to get a verification code via SMS on your mobile phone. Enter a desired password.

5.4 Tap on "Confirm" to finish your registration.

6. Add New Device

There is two pairing mode Auto & EZ mode.

- 6.1 The Switch automatically enter into pairing mode when each time power on, the WiFi LED rapidly blink (Auto Mode).
- 6.2 To connect quick flash mode (EZ mode)
- 6.3 Tap random button of Switch around 5s until the WiFi LED rapidly blink or can hear the relay "Di Da" voice.
- 6.4 Connect your phone to local Wi-Fi.
- 6.5 Enable your phone Bluetooth.
- 6.6 Tap "+" icon on the App to add new device, the app will automatically discover all switches which are standby on pairing mode.
- 6.7 Follow the app tips to fix the WiFi network name and password till new device register successful.

7. How to connect the Smart AC Switch to Alexa

7.1 Open the Alexa app on your phone. After successful login, tap on the menu in the upper left corner.

Home page, select "Settings"

Tap "Set Up A New Device" to set up the Amazon Echo.

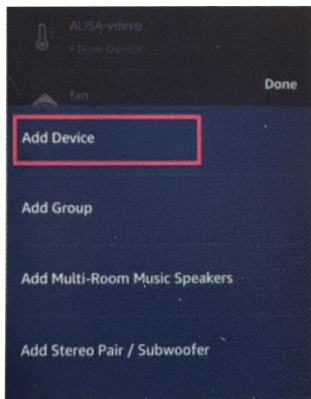

7.2 Choose your Amazon Echo device type and language for connecting. Press and hold the small dot on the device until the light turns yellow. Then tap "Continue" to connect to the hotspot.

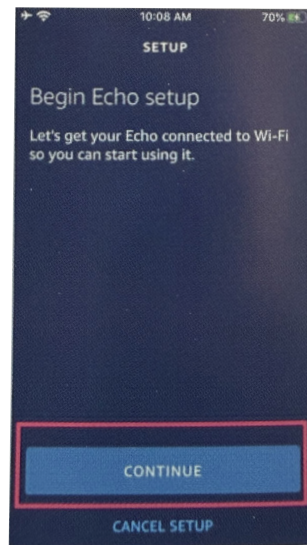

After connecting to the Amazon Echo hotspot, return to the page. At this point, the connection is successful. Tap "Continue" to proceed to the next step. Choose a Wi-Fi network to connect to. Amazon Echo will take a few minutes to try to connect to the network.

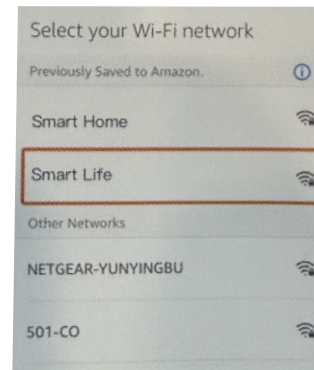

After the network connection is successful, tap "Continue." An introduction video will appear. After the video ends, tap "Continue" to jump to the Alexa Home page. You have now completed the Amazon Echo's configuration process.

7.3 Key Step – Link Skill

7.3.1 Tap on "Skills" in the Alexa app menu.

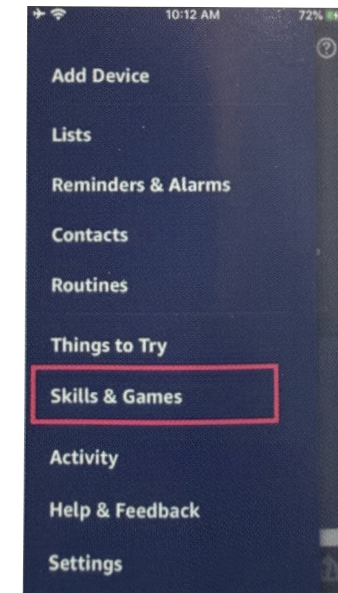

7.3.2 Then search for "Smart Life." Tap "Enable" to enable the Skill.

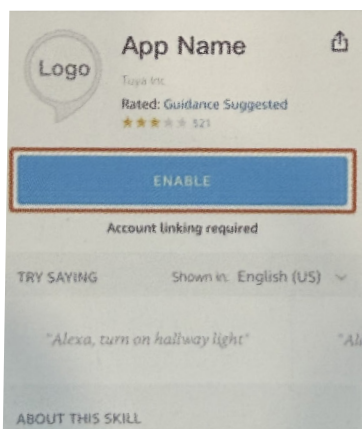

7.3.3 Enter the Smart Life APP account and password, then tap "Link Now" to link your Smart Life account to enable the Skill. Now you can start your smart home journey.

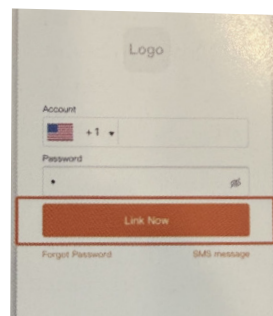

7.3.4 Common commands

Control the device via voice commands. Now you can control your smart device with Echo. You can control your device (such as your bedroom light) with the following commands:

Alexa, turn on/off bedroom light.
(Turn on/off the light)

Alexa, set bedroom light to 50 percent.
(Set the light to any brightness)

Alexa, brighten/dim bedroom light.
(Increase/weaken the brightness of the light)

Alexa, set bedroom light to green.
(Adjust the color of the light)

8. How to control the Smart AC Switch with Siri

8.1 The current shortcut function of the system with iOS 13.0 can realize the control of intelligent products. The operation modes are as follows:

8.1.1 Open the app, enter the scene creation page, edit the scene name, add the execution action, and click "Add to Siri", select the scene you want on the Siri shortcut page to add.

8.1.2 Fill the phrase in the box under "When I say". Then Siri can use it to tell your app to run this shortcut. For example, you can create a phrase: Backhome

8.1.3 You can say to Siri: Backhome. The mobile phone will pop up the scene that has been set, and the device set in the scene will perform the corresponding action.

8.2 The function of the system with iOS 12.0 can realize the control of intelligent products. The operation modes are as follows:

How to control the device by Google Home

- Launch Google Home app, and tap Home control
- Under Devices menu tap the "+" icon in the bottom right

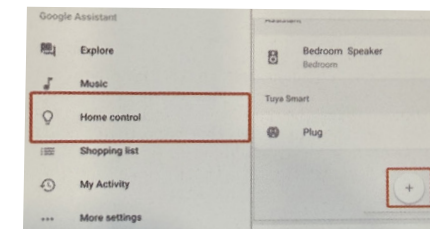

- Tap Tuya Smart from the list, enter your Tuya Smart account name and password then tap login
- After login successfully all your Tuya smart account devices will display on the list
- Tap Done on the upper right, then tap GOT IT to finish
- In Home control, you will see all those devices supported by Google Home voice control by commands

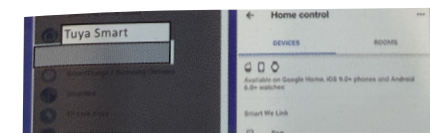

9. How to change WiFi from 5.0 to 2.4 Hz?

It is recommended that you log in to the router's background to select the router's frequency mode, open the router management page (usually on the label on the bottom of the router marked with the address of the management page), select the wireless setting 2.4GHz, set to open the attempt.

10. Troubleshooting Tips

- Please check whether the device is connected with power and your phone is connected with Wi-Fi.
- Check routers: If the router is dual-band router, please select a 2.4GHz network to add device. You also need to open the router broadcasting function.
- If you have bought several switches and find that they can't connect at the same time, maybe it is the WiFi router can't connect enough. Try to add another router or reduce the WiFi connection of other smart products.

Contact Information



Ledgebit Technologies Private Limited,
401, Vipul Trade Center, Sec 48,
Gurugram, Haryana 122018



www.ledgebit.com



sales@ledgebit.com



+91-9810320256