



# Smart Security Kit

User Manual



Please read this manual carefully before use and keep it for future reference.

## Features

- Based on the SmartLife home platform, works with most TUYA smart products.
- On-site high-decibel alarm, flashing lights, and other alarm modes.
- Home Arm, Away Arm, Disarm
- Low-battery detection
- System power-off detection
- Tamper detection
- Built-in battery
- Supports Amazon Alexa and Google Assistant.

## Download & Install the APP

1. Go to your App Store & search the "Smart Life" & install the app.
2. Input account name and password to login. If you don't have an account, please register an account first. System will identify your country automatically. You can use your mobile phone number as your account name.
3. Tap on "Next" to get a verification code via SMS on your mobile phone. Enter a desired password.
4. Tap on "Confirm" to finish your registration.

## How to connect WiFi network #1:

### Default mode

Open the APP homepage, press "+" in the upper right corner to add devices → select "ALL devices" → select "Alarm system".

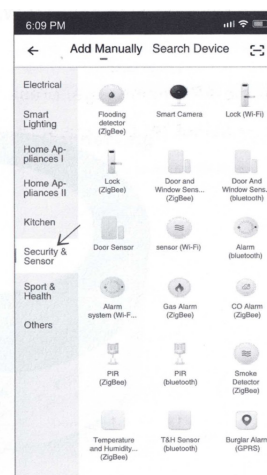

Re-open the smart siren switch, reconnect the power. The indicator flashes quickly and is ready to connect to WiFi.



Confirm the indicator quickly blinks → Enter WiFi password (2.4G WiFi only) → OK.

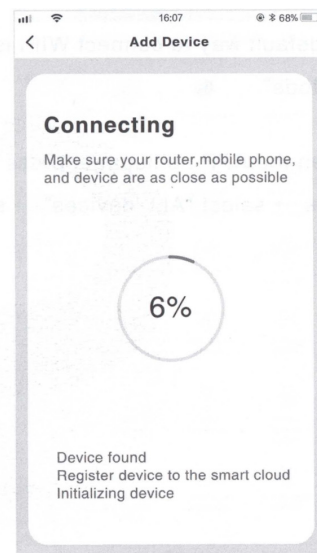
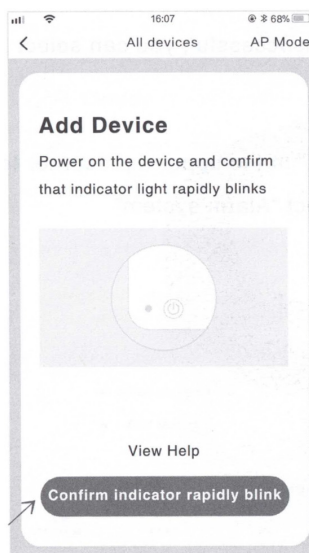

# How to connect WiFi network #2:

## Compatibility mode

If the default way to connect WiFi is unsuccessful, you can select "AP Mode".

Open the APP homepage, press "+" in the upper right corner to add devices → select "ALL devices" → select "Alarm system".



Click on "AP Mode" at the top right of the app.

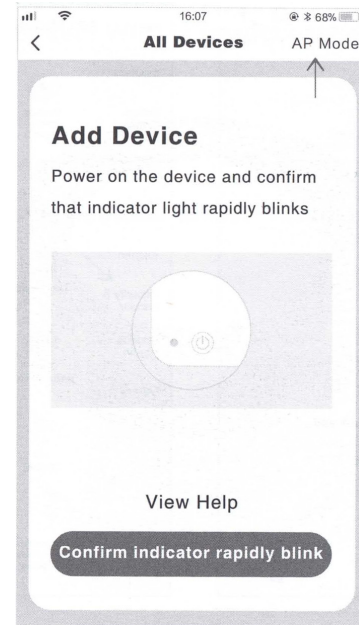

Re-open the smart siren switch, reconnect the power.

The indicator light flashes quickly. Press and hold the RESET button for 5 seconds, the indicator light flashes slowly and is ready to connect.



Confirm the indicator slowly blinks → Enter the network password (2.4G WiFi only) → OK → Go connect.

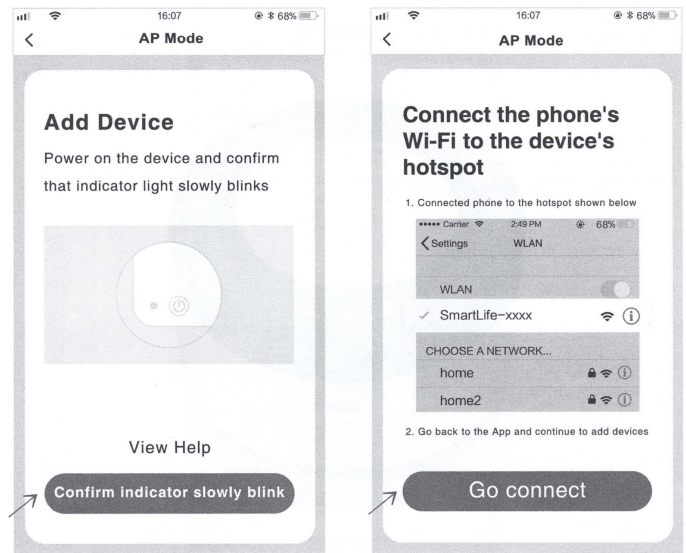

Find "SmartLife-xxx" in the WiFi list of your mobile phone and click Connect → Return to the SmartLife APP.

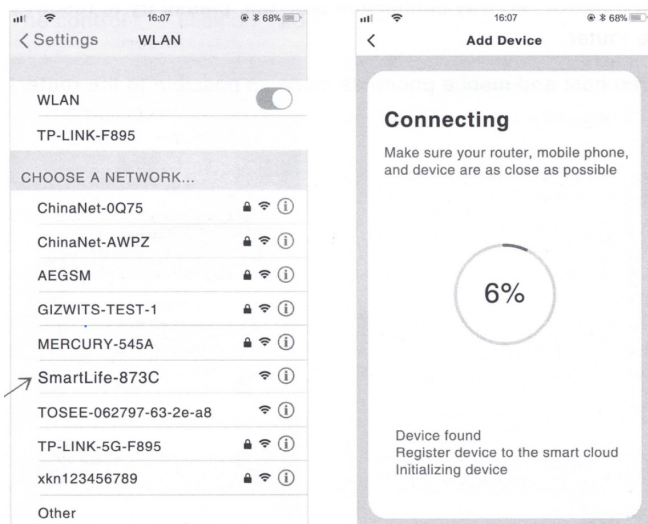

## WiFi connection notes

1. Does not support 5G router.
2. If the above two connection methods both fail, please try restarting the router.
3. Keep the siren host and mobile phone as close as possible to the router.

## Add detectors and remotes

Method 1: Add detectors and remotes via APP

Click on the APP homepage "Accessories" → select "The detector" or "The control" → click "Add".

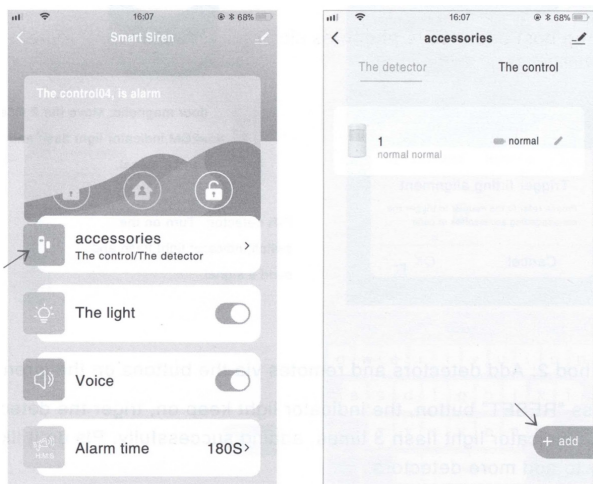

Click "OK" → smart siren light stays on → accessories send signals → smart siren light flashes 3 times, adding is successful.

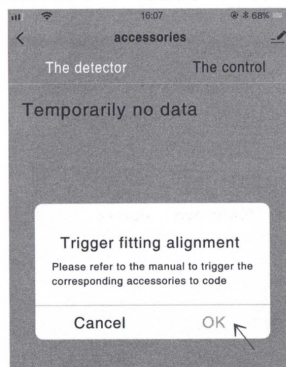

Method 2: Add detectors and remotes via the buttons on the siren

Press the RESET button, the indicator light stays on. Trigger the detector → siren indicator light flashes 3 times, adding successfully.

Please follow this method to add more detectors.

## Edit the accessory name

### Install the siren

Move the bracket to the unlock direction, take out the bracket and fix it with screws. Install the siren body to the bracket and rotate it to the lock direction.

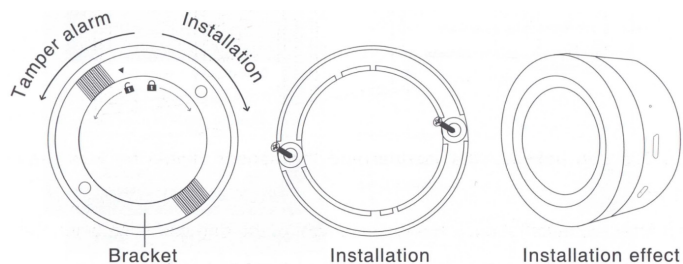

## WiFi connection notes

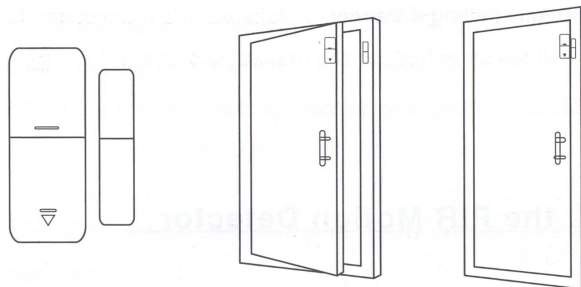

1. The gap between the magnet and the sensor should be less than 10 mm.
2. After installation, if the indicator light of the detector is on when the door is opened, it proves it is installed successfully.
3. If the indicator light of the door detector flashes when triggered, it means the battery is low and you need to change the battery as soon as possible.
4. The transmission distance of the detectors is less than 80 meters in open areas. Please test the distance before installing. Obstacles will affect the transmission distance.

## Install the PIR Motion Detector

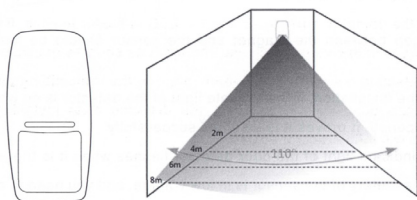

To avoid false alarms, please pay attention to the following points when installing the PIR motion detector

1. Do not face the glass door/window.
2. Do not face big objects that are easy to swing.
3. Do not face cold or hot air vents or heat sources.
4. Furniture, mini landscapes, or any other obstacles should be away from the detecting scope.
5. Do not install two or more detectors in the same area, as it will cause interference when alarming.
6. When the detector is triggered and the LED indicator flashes, it means the battery is low. Please replace it as soon as possible.
7. The detecting distance is less than 8 meters, and the transmitting distance is less than 80 meters. Please test the distance after installation. Obstacles will influence the distance.

## Specifications

Indicator light keeps flashing: not connected to WiFi

Arm: alarm with sound and light flash

Home Arm: only light flash alarm

Disarm: only SOS alarm available

Remote controls: max 8

Detectors: max 24

Volume: high / medium / low

Beep time: 1-180 seconds adjustable

Timing control: arm / home arm / disarm

Accessories frequency: 433 MHz (can be customized to any frequency between 300-912 MHz)