



Smart Wi-Fi Temperature & Humidity Sensor

User Manual



Please read this manual carefully before use and keep it for future reference.

Product parameter:

Size	73 × 27 × 25 mm
Input voltage	DC 3V LR03 ×2
Quiescent current	≤20uA
Low power undervoltage	≤2.4V
WiFi	802.11b/g/n 2.4GHz
Temperature Measure Range	-15°C - +60°C
Humidity Measure Range	10% - 90%RH
Water Proof level	IP65

Download & Install the APP

1. Go to your App Store & search the "Smart Life" & install the app.
2. Input account name and password to login. If you don't have an account, please register an account first. System will identify your country automatically. You can use your mobile phone number as your account name.
3. Tap on "Next" to get a verification code via SMS on your mobile phone. Enter a desired password.
4. Tap on "Confirm" to finish your registration.

Appearance introduction

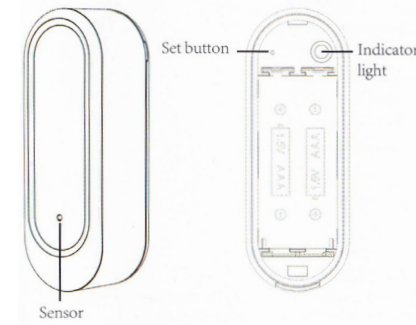

Bluetooth mode

First turn on the Bluetooth on your phone → open the Smart Life APP, select "+" → long press the sensor for 5 seconds → the sensor indicator flashes, and the mobile phone APP displays "Devices to be added". Enter correct password of WIFI then press "Next", the device will automatically connect to the network.

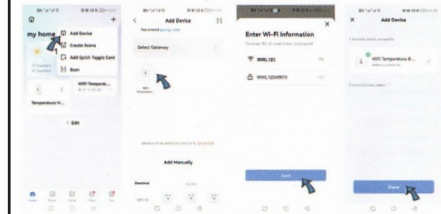

After connect WiFi successfully, click the sensor icon to enter the app interface and do some setting.

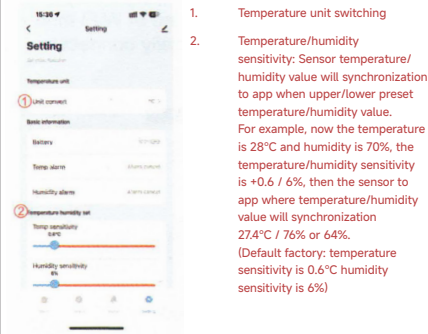

1. Temperature or Humidity Calibration
2. Alarm push switch

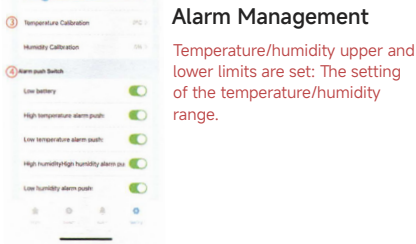

Alarm Management

Temperature/humidity upper and lower limits are set: The setting of the temperature/humidity range.

Intelligent Linkage

When the ambient environment change, you can do intelligent linkage.
For example, the air conditioner will be on automatically when the room temperature surpass 35°C.
And the humidifier will spray when the humidity is lower than 20% RH.

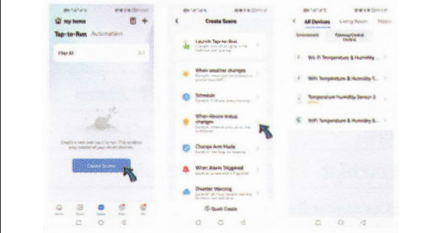
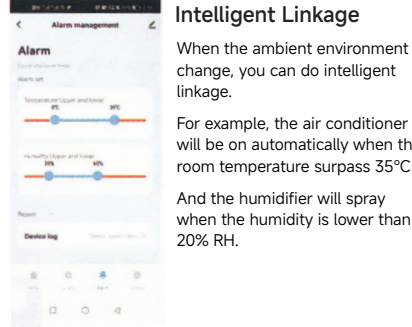

Share devices
You can share your added devices with your family members, so they can also monitor the ambient environment.
Temperature Unit Selection in APP
You can choose °C or °F as the temperature unit through app.
Third-party Voice Control
Works with amazon alexa, google assistant.

Contact Information

- Ledgebit Technologies Private Limited, 401, Vipul Trade Center, Sec 48, Gurugram, Haryana 122018
- www.ledgebit.com
- sales@ledgebit.com
- +91-9810320256