



Smart Wi-Fi PIR Motion Sensor

User Manual



Please read this manual carefully before use and keep it for future reference.

Overview

The infrared detector is used to detect when an intruder enters the room. The human body moving sensor can capture the infrared rays of the intruder, enter the alarm state, notify the intruder through the timely push of the WiFi, and timely link the IP camera to record the evidence to the user's mobile phone. Send a signal. Suitable for home, hotel, office and other places.

Detection coverage area

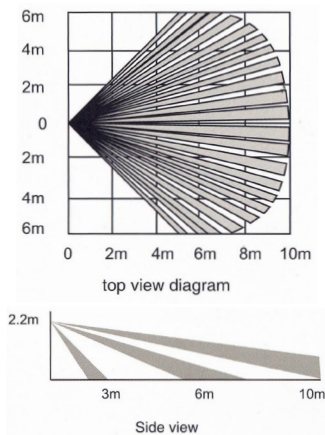

Product parameters

Input voltage: DC 5V/1A, Type-C

Support: Arm / Disarm

Standby current: $\leq 20\text{mA}$

Alarm current: $\leq 60\text{mA}$

Sound level: $\leq 80\text{dB}$ (within 1m)

Detection distance: 6m

Detection angle: 90°

Working temperature: -10°C ~ 55°C

Working humidity: 10% ~ 90%RH

WiFi: IEEE 802.11 b/g/n 2.4GHz

Product instructions

Connect the power supply to the WIFI PIR sensor. (Device parts labeled: Set key, Type-C)

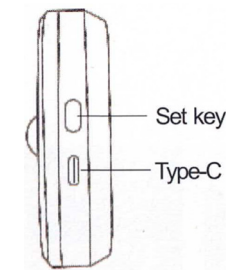

Download the Smart Life app in major app stores or scan the QR code below. (iOS / Android)



iOS/Android

First turn on the Bluetooth in mobile phone → open Smart Life app and choose "+" → press and hold on the set key for more than 5 seconds to let the indicator flash.

Then will see "Discovering devices" on the app. Press "add", enter the correct password, then press "Next". Finally, it will connect the Wi-Fi network automatically.

Network connection successfully as below. User can Arm / Disarm the PIR motion sensor, and click "history records" to check more message records, and click "Setting" to do more function setting.

Function Introduction

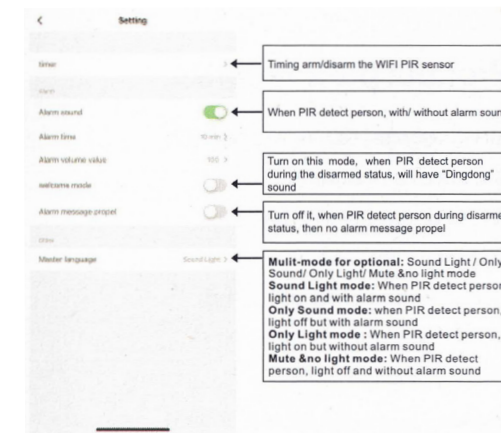

Share devices

You can share your added devices with your family members, so they can also monitor the ambient environment.

Intelligent Linkage

When PIR detect person, can link to turn on the Tuya smart light. When no one state, can link to turn off the Tuya smart light.

