



Smart Zigbee Wall Switch

Installation & User Manual



Please make sure to turn off the main power switch before installation.

Overview

Thank you for choosing our smart products. Please read this manual carefully before use to ensure that you can use the product safely. At the same time, keep the manual properly for reference when necessary.

Smart key switch supported lamps: incandescent lamp, energy-saving lamp, LED lamp, tungsten lamp, fluorescent lamp, etc.

Product features

The product shape is simple, beautiful and generous.

The housing is made of 75° C high flame retardant material and the internal quality is guaranteed by wave soldering process.

Flat Ceiling Mounting

Product name	N-L switch No neutral switch Composite switch	N-L switch Composite switch
Wireless type	ZigBee 2.4G	WiFi 2.4G + BLE
Wireless standard	IIEEE802.15.4	IIEEE802.11b/g/n +BLE4. 2
Working temperature	-20°C-45°C	-20°C-45°C
Working humidity	10%-90%RH (no condensation)	10%-90%RH (no condensation)
Storage temperature	-20°C-45°C	-20°C-45°C
Store humidity	30%~+70%RH	30%~+70%RH

Product size

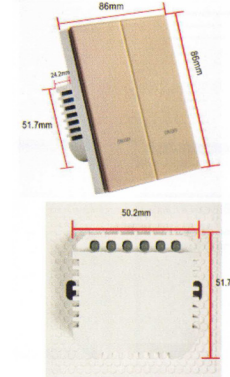

Installation

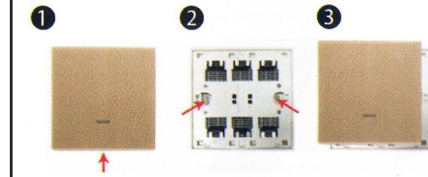

1. Open the button panel of the switch with your hand
2. Drive the screw into the screw hole where the switch bottom housing is installed
3. Put the button panel on the switch

Wiring diagram

(N-L switch and Composite switch Wiring Diagram)

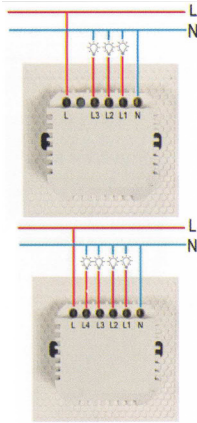
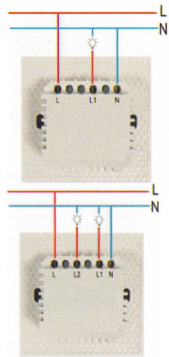

no neutral switch wiring diagram

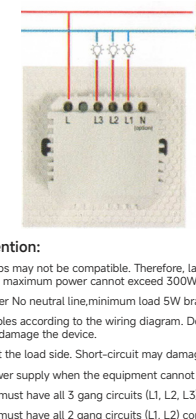
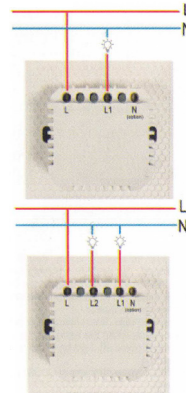

Scenario switch wiring diagram
(neutral wire N and live wire L only) 1,2,3,4 gang do not need wiring

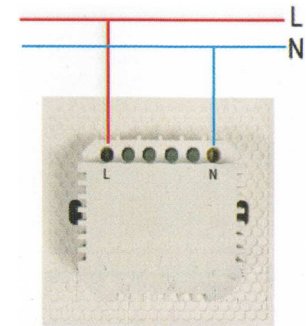

Points for attention:

Small-wattage lamps may not be compatible. Therefore, large-wattage lamps need to be replaced. The maximum power cannot exceed 300W/circuit.
No connection under No neutral line, minimum load 5W brand lamps.
Strictly connect cables according to the wiring diagram. Do not connect wrong cables, which may damage the device.
Do not short-circuit the load side. Short-circuit may damage the device.
Disconnect the power supply when the equipment cannot be controlled.
The 3 gang switch must have all 3 gang circuits (L1, L2, L3) connected to the load.
The 2 gang switch must have all 2 gang circuits (L1, L2) connected to the load.

Network distribution preparation

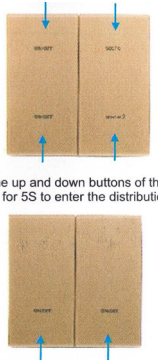

Long press any of the up and down buttons of the compound switch and the light flashes for 5S to enter the distribution network state

Hold down any button for 5S. The indicator blinks and enters the power distribution network

Pairing Preparation

Turn the 2.4G Wi-Fi router on, please note that 5G WiFi router is not available. Download the smart life app firstly in IOS APP store or Google Play, or scan the QR code as below shown.



IOS & Android System

Pairing operation of WiFi version

1. Long press any button on the switch panel till LED indicator flash quickly
2. Then add device like the follow pictures

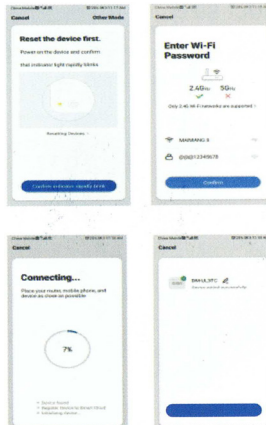
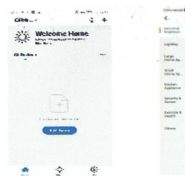

Pairing operation of Zigbee version

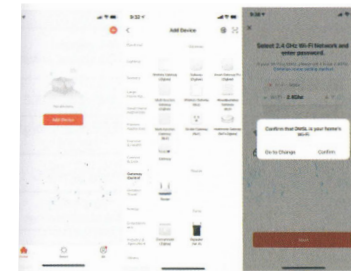

Scan the Tuya smart QR code on the box to download and open it

Click "Add Device" and select "Gateway Central Control" to add your Zigbee gateway.

After entering WIFI and password, click Next, select "confirm indicator flash" and click Next.

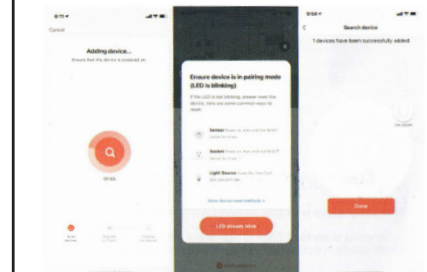

Wait for the gateway to be configured

On the gateway interface, click "Add Subdevice" and confirm that the indicator blinks quickly

Long press the distribution button for 5 seconds, and wait for the light to flash

The smart button switch is configured successfully