



Smart Wi-Fi Wall Switch

Installation and User Manual



Please make sure to turn off the main power switch before installation.

Functional Features

- Ultra-low power consumption. The power consumption of the switch itself is less than 0.05W.
- The switch has a timing function, which can be set to turn on or off at a specific time.
- Power-on state setting function:
 - Power failure: The switch is always turned off when power is restored after a power failure.
 - Power-on: The switch is always turned on when power is restored after a power failure.
 - Power-off memory: Every time the power is cut off and then restored, the switch remembers the state before the power was cut.
- Indicator light control function:
 - Turn off the indicator light. Whether the switch is on or off, the indicator light remains off.
 - The indicator light indicates the switch state. When the switch is on, the indicator light is on, and when the switch is off, the indicator light is on.
 - The indicator light indicates position. When the switch is on, the indicator light is off, and when the switch is off, the indicator light is on.
- Multi-control association function.
- Intelligent voice control support, such as Amazon Alexa and Google Assistant.

Tutorial For Voice Control



Alexa TUTORIAL



Google Home TUTORIAL

Tutorial For Voice Control

- Wi-Fi supports only a 2.4GHz network (802.11 b/g/n).
- Supports only one-way (single-pole) circuits. Not compatible with 2-way circuits.
- Can be used with or without a neutral wire.
- This product does not have a relay function.
- Basic electrical wiring knowledge is required. Otherwise, please consult a professional electrician. Always ensure power is turned off before installation.
- The ON/OFF button can also be used as a reset button. Press and hold any key for 10 seconds to reset the smart switch to factory settings. Only do this if you are sure you want to erase all settings.

Download & Install the APP

- Go to your App Store & search the "Smart Life" & install the app.
- Input account name and password to login. If you don't have an account, please register an account first. System will identify your country automatically. You can use your mobile phone number as your account name.
- Tap on "Next" to get a verification code via SMS on your mobile phone. Enter a desired password.
- Tap on "Confirm" to finish your registration.

Wiring Diagram

Please select the wiring method according to the actual situation. Note: Disconnect the power supply before wiring.

EU Switch Wiring Method

Neutral wire is required on the switch according to the following diagram. Neutral wire Live wire Switch 4,5,6,7. Lighting (connected between L1, L2, L3, L4 and Neutral wire)

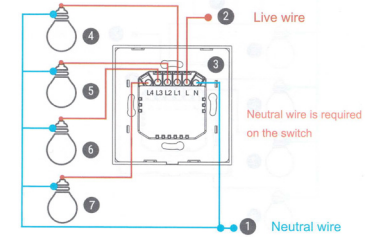

No neutral wire required

No neutral wire is required on the switch according to the following diagram. Neutral wire Live wire Switch Capacitor (must be connected to L1 and Neutral wire) 5,6,7,8. Lighting (connected between L1, L2, L3, L4 and Neutral wire)

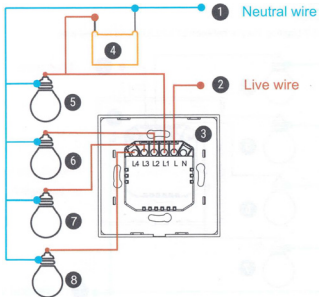

US Touch Switch Wiring Method

Neutral wire required Neutral wire is required on the switch according to the following diagram. Neutral wire Live wire Switch 4,5,6,7. Lighting (connected between L1, L2, L3, L4 and Neutral wire)

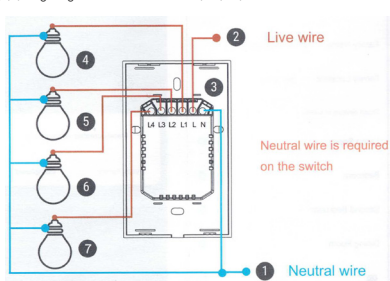

No neutral wire required

No neutral wire is required on the switch according to the following diagram. Neutral wire Live wire Switch Capacitor (must be connected to L1 and Neutral wire) 5,6,7,8. Lighting (connected between L1, L2, L3, L4 and Neutral wire)

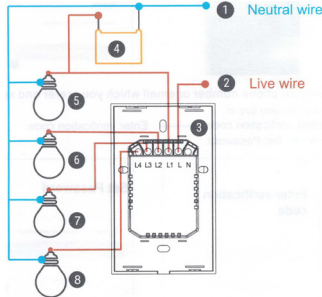

APP Pairing Switch

Bluetooth Mode (Default Setting)

Turn on your phone's Bluetooth and Wi-Fi.

Power on the switch. The indicator light will automatically enter fast flashing mode when powered on.

Note:

- If the switch is not connected to the app within 5 minutes, the indicator will stay on.
- If the indicator stops flashing, press and hold the button for about 10 seconds until it starts flashing again.
- Whether the indicator is flashing fast or slow, Bluetooth pairing can be performed.

Open the Smart Life App. A pop-up window named "Device to be added: 1" will appear at the bottom. Click "Add".

Note: If no pop-up appears, restart the app.



Enter the Wi-Fi account and password, click "Next", and wait for the connection to complete. Then click "Done".

Note: Wi-Fi only supports 2.4GHz networks (802.11 b/g/n).

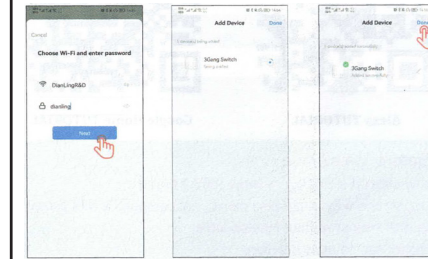

Contact Information



Ledgebit Technologies Private Limited, 401, Vipul Trade Center, Sec 48, Gurugram, Haryana 122018



www.ledgebit.com



sales@ledgebit.com



+91-9810320256