



# Smart Zigbee Gas Sensor

User Manual



Please read this manual carefully before use and keep it for future reference.

## Product Description

It is a Zigbee flammable gas alarm, which is used to detect the leakage of flammable gas and prevent the harm caused by gas leakage. The alarm uses a high-stability semiconductor gas sensor, which has the characteristics of high stability & small sensitivity drift. When a flammable gas leak is detected & the concentration value set by the alarm is reached, the alarm will send an alarm signal. This product is used indoors where leakage may occur, such as kitchens.

## Specifications

- Input voltage: DC3V LR03
- Static Current:  $\leq 10\mu A$
- Alarm Current:  $\leq 120mA$
- Low-voltage notification:  $\leq 2.4V$
- Alarm Sound Level: 80dB / 1m
- WiFi: 802.11 b/g/n
- Detecting Range: 20m<sup>2</sup>
- Installation Method: Ceiling Mounted
- Working Temperature: -10°C ~ +50°C
- Working Humidity:  $\leq 95\%RH$
- Size: 90 × 90 × 40mm

## Product Diagram



## Parameters

- Working Voltage: AC85V-250V
- Average Consumption:  $\leq 1.5W$
- Alarm Sound: 70dB (1 meter)
- Alarm Density: 7%LEL  $\pm 3\%LEL$  (CH4)
- Zigbee Standard: IEEE802.15.4
- Working Frequency: 2.405-2.480GHz
- Working Temperature: -10°C to +50°C
- Working Humidity: Max. 95%RH

## Installation Diagram

Before installation, please confirm whether the detecting gas density is heavier or lighter than air. If detecting gas is heavier than air, Examples: LPG. Installation requirements: Install at 0.3-1m height from floor & Distance to gas source should be less than 1.5m. If detecting gas is lighter than air, Examples: Natural gas, Manufactured gas & Marsh gas. Installation requirements: Install at 0.3-1m height from ceiling & Distance to gas source should be less than 1.5m.

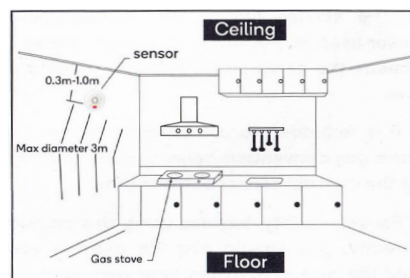

Installation diagram

## How to Use

1. The Zigbee sensor cannot work standalone. It must connect to a Tuya Zigbee Gateway before use.
2. Download the Smart Life App from the application store, or scan the QR code, then register and log in according to the app instructions.



iOS/Android

3. Power on the gas detector. The LED light flashes with three colors and then stays green, which means initialization is successful. (Initialization time: 5 mins)

- Red LED flashing: Waiting for connection with gateway.
- Yellow LED flashing: Not connected with gateway.



Add a gateway into the app according to its user manual. If the gateway has already been added, ignore this step.

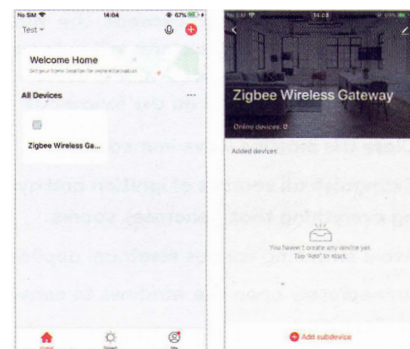

## After adding the gateway:

- Click "Add Zigbee Device".
- Use a pin to press RESET for 5 seconds until the indicator flashes quickly for configuration.
- The app will search nearby devices automatically.

After about 25 seconds:

- The gas detector indicator will stay ON
- Pairing is successful

The gas detector icon will then appear in the app interface.

Click it to finish setup.

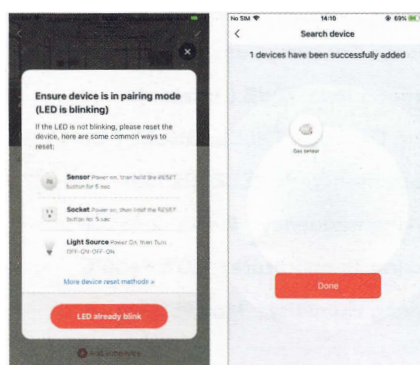

After successful connection, In the gas detector interface, click SET. Available settings include Gas self-detecting, Alarm sound modification, Alarm time settings.

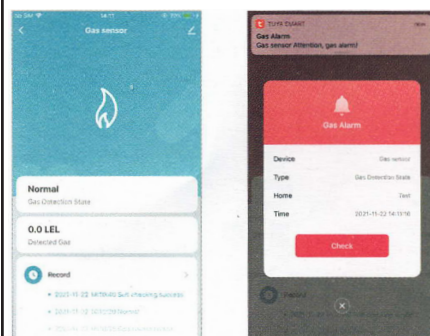

## Indicator Status

Status	Color	Indicator	Alarm Sound
Power	Green	Keeping on	No
Alarm	Red	Flashing	Di-Di alarm. Multiple ringtones available in App
Malfunction	Blue	Keeping on	Di
Connecting Gateway Success	Green	Keeping on	No
Not Connecting Gateway	Yellow	Flashing	No

## Product Testing

This product has a self-test button, and there is also a self-test button in the app. The self-test function can be used to detect whether the alarm and buzzer are working normally.

When the self-test is pressed:

- The red LED flashes
- The buzzer beeps

## Alert Handling

When the concentration value of natural gas or liquefied petroleum gas reaches or exceeds the alarm concentration value, the alarm automatically enters continuous alarm status.

At this moment, do the following immediately:

1. Close the pipeline valve immediately.
2. Extinguish all ignition sources and avoid anything that generates sparks.
3. Avoid switching electrical appliances.
4. Open the windows immediately to ventilate indoor air.

## Malfunction Analysis & Troubleshooting

Malfunction Phenomena	Reasons	Troubleshooting
Warming up after power on (LED keeps flashing)	1. Long time without power 2. Tested with gas during warm-up	1. Power on detector and aging test for 24 hours 2. Do not test during warm-up
Blue light keeps on and buzzer keeps beeping	Detector fault	Contact dealer for repair
Connecting gateway failure	1. Gateway problem 2. Green indicator not flashing	1. Try adding another Zigbee sensor to confirm gateway works properly 2. Use a pin to hold RESET key for 5 seconds until it sounds "Di" and indicator flashes, then try again

## Tips

1. It is normal for the surface of the case to become slightly warm during operation.
2. It is recommended to remove the alarm during decoration work.
3. Avoid spraying aerosol directly on the gas alarm.
4. If the alarm is used for a long time, oil stains may appear in the gas convection holes, affecting sensor sensitivity. Do not let detergent enter the body. Retest the product after cleaning.
5. The semiconductor sensor used in the alarm has a service life of 5 years. Replace it in time after exceeding the service life.
6. Do not use a lighter to test the alarm gas convection holes, as this may damage the internal sensor.
7. For your safety, besides using this product correctly, stay alert in daily life and strengthen safety awareness and prevention.

## Contact Information



Ledgebit Technologies Private Limited,  
401, Vipul Trade Center, Sec 48,  
Gurugram, Haryana 122018



[www.ledgebit.com](http://www.ledgebit.com)



[sales@ledgebit.com](mailto:sales@ledgebit.com)



+91-9810320256