

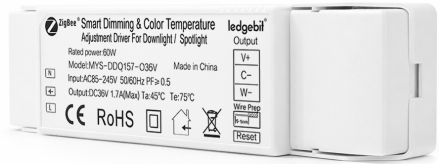

Smart Dimmer Driver

User Manual



Please read this manual carefully before use and keep it for future reference.

Thank you for choosing our product!

This is LED driver can connect with 36V 3-wire downlight/spotlight to make downlight/spotlight be smart.

Then control the downlight or spotlight from the Smart Life app or the Smart home control panel.

Basic Parameters:

1. DC-DC 21-42V output constant current drive.
2. Suitable for AC 85-240V voltage input; with good protection functions: open circuit protection, short circuit protection.
3. High reliability, low cost.
4. Natural cooling.
5. Suitable for 36V downlight/spotlight.

Wiring diagram

1. Zigbee led driver can connect with 2 wires 36V downlight/spotlight for dimming the brightness only.
2. Zigbee led driver can connect with 3 wires 36V downlight/spotlight for dimming the brightness and adjust color temperature.

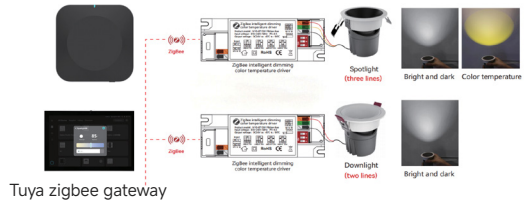

Product Presentation

Reset Button:
After powering on, press it 5 times in a row. The light will light up and breathe several times, indicating that the light has been successfully reset and entered the network configuration state.

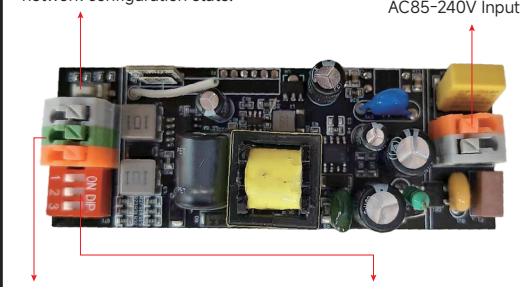

DC21-42V output
Common positive (V+)
White light negative (C-)
Warm light negative (W-)

The default DIP switch current is 150mA.
Both sides are turned on simultaneously.
When 1 is on, it is 280mA.
When 2 is on, it is 200mA.
When 3 is on, it is 220mA.
When 1 and 2 are on, it is 300mA.
When 2 and 3 are on, it is 260mA.
When 1, 2, and 3 are on, it is 350mA.

Product Specification

Output characteristics	Maximum output current	350mA
	Output voltage range	21-42V
	Current accuracy	± 5.0%
	Line regulation	± 5.0%
	Load regulation	± 5.0%
Input Characteristics	Voltage range	85-240V/AC
	Maximum input current	350mA
	Startup time	<1.00S
Protection Operating Environment	Open circuit protection	Open-circuit voltage <42VDC; when the output is open-circuited with no load, the input is normal and the product is not damaged.
	Short circuit protection	A short circuit occurs at the output, but the power supply is protected from damage. Normal operation will resume after the fault is corrected.
	Overload protection	A short circuit occurs at the output, but the power supply is protected from damage. Normal operation will resume after the fault is corrected.
Operating Environment Dimensions	Operating temperature	-30~+45°C
	Operating humidity	20-90%RH
	Storage temperature and humidity	-40~+80°C; 10-95%RH
	Average lifespan	≥9000Hrs(27°C)
Dimensions	Dimensions	115*35*24mm (L*W*H)
Weight	Weight	0.06kg
PCB Material	FR4 (glass cloth-epoxy resin copper-clad laminate)	
Precautions	1. Parameters not otherwise specified in the table: Input voltage 85-240V/AC, ambient temperature 27°C.	

How to set up

Use your smartphone to scan below QR code, or search "Smart Life" app in Google Play Store or APP Store to download and install.



Create an account with your mobile number and authentication code.

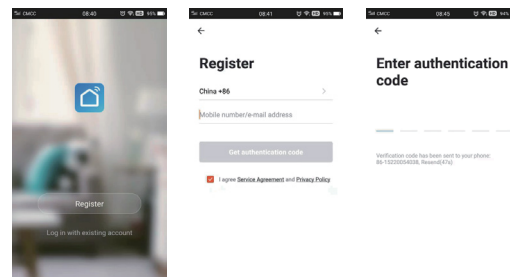

1. Power on your device, Connect your mobile to your Wi-Fi router,click "+" in the upper right corner of homepage or click "Add Device". (Please see Figure 1)
2. Choose a Zigbee gateway (Please see Figure 2)

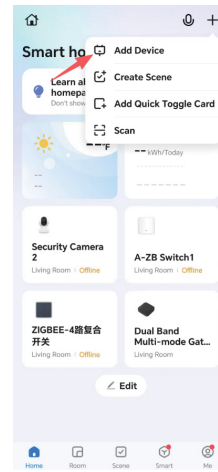

Figure 1

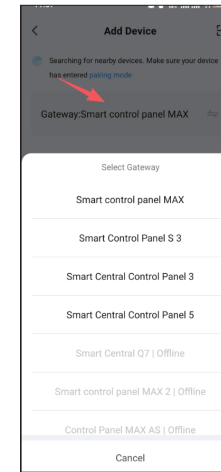

Figure 2

Press the driver reset button 5 times until the light flashes.



Reset button

