

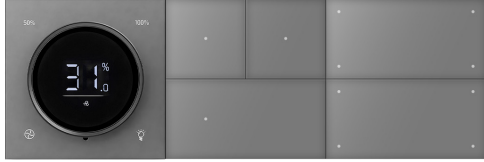

# X39R Smart Modular Switch

Installation and User Manual



Please make sure to turn off the main power switch before installation.

## Product Overview

Thank you for purchasing our X39R Switch series. Please read this user manual carefully before use to ensure safe operation. Keep this manual properly for future reference.

## Product Features

1. Sleek and Aesthetic Design
2. Dual Quality Assurance
3. Shell made of 75°C high-flame-retardant material
4. Internal components feature wave soldering technology
5. Stable Automatic Reconnection
6. Physical button switch automatically reconnects after power restoration, ensuring reliability.

## Product specification

Product Name	Zigbee neutral push button switch	Bluetooth neutral push button switch
Wireless Type	Zigbee 2.4G	Bluetooth 2.4G
Wireless Standard	IEEE802.15.4	Bluetooth 4.2/5.0
Operating Voltage	100-240V~	100-240V~
Operating Temperature	-20°C~45°C	-20°C~45°C
Output Power	Capacitive load: 400W per gang Resistive load: 800W per gang	Capacitive load: 400W per gang Resistive load: 800W per gang
Operating Humidity	10%-90%RH (No Condensation)	10%-90%RH (No Condensation)
Storage Temperature	-20°C~45°C	-20°C~45°C
Storage Humidity	30%~+70%RH	30%~+70%RH

## Product Dimensions

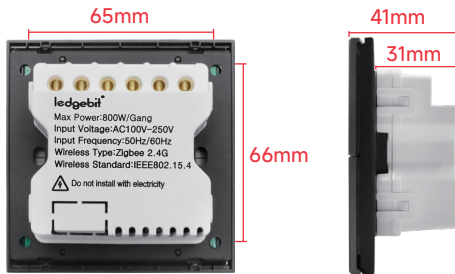
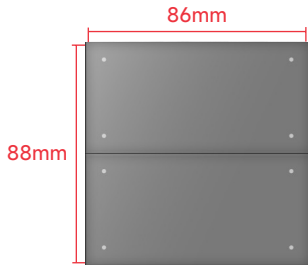

## Product Installation

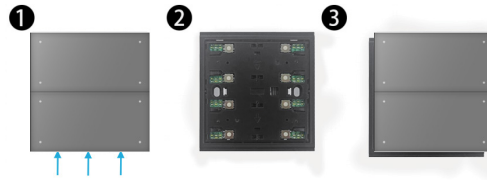

1. Remove the panel.
2. After removing all panels, proceed with wiring according to the wiring diagram. After completing the wiring, secure the panel using screws on both sides.
3. Once secured, align the panel and press it back into place. Ensure it is pressed firmly, as insufficient pressure may affect the button's rebound.

## Product Wiring

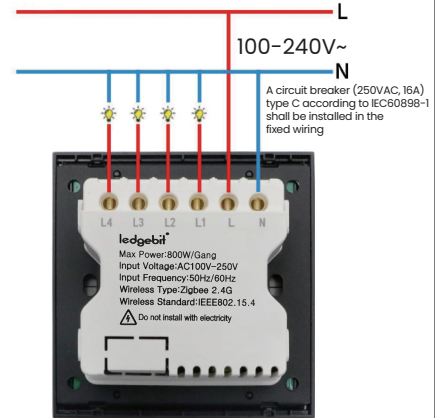

1. The figure above shows the wiring diagrams for 4-gang and 8-gang switches.
2. For a 1-gang switch, the output is L2; for a 2-gang switch, the outputs are L1 and L3; for a 3-gang switch, the outputs are L1, L2, and L3.

## Preparing for Network Setup



Download and open the app

Scan the QR code in the image below or search for "Smart Life" in your app store to download and install the app

## Adding a Zigbee Device

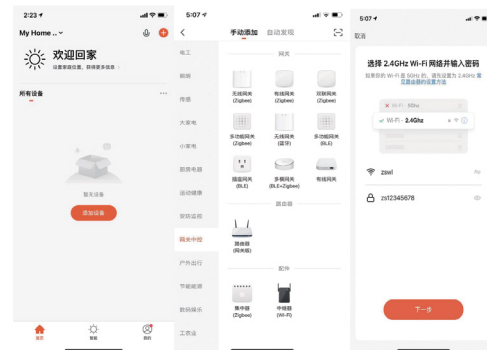

- Click "Add Device", then select "Gateway Hub" on the left to add your Zigbee gateway.
- Enter your WiFi password and click "Next"—the indicator light should flash rapidly.
- Click "Next" again to proceed.

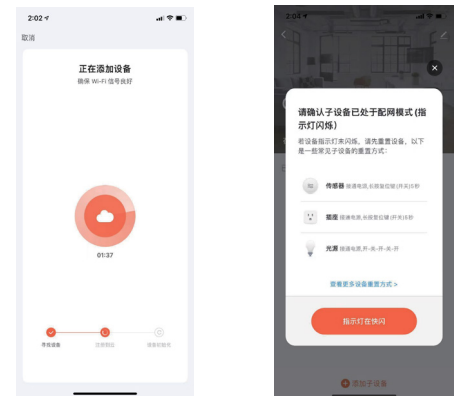

- Wait patiently for the gateway to configure. Once the gateway is successfully added,
- Press and hold any switch button for seconds to enter pairing mode. The panel indicator light will flash.
- In the gateway interface, click "Add Sub-Device" and confirm that the indicator light is flashing rapidly.



- Wait patiently for the device to be added.
- The smart physical button switch has been successfully added.

## Adding a Bluetooth Device

Turn on your phone's Bluetooth and follow the steps in "Adding a Zigbee Device" to add the Bluetooth device. Note that you must first add the Bluetooth gateway, then add the Bluetooth device from the gateway interface. The steps are the same as in "Adding a Zigbee Device".

## Non-Warranty Terms

1. Unauthorized repair, misuse, collision, negligence, abuse, liquid ingress, accident, modification, use of non-original converter accessories, or tampering with/tampering with labels/anti-counterfeit marks.
2. Exceeding the three-year warranty period.
3. Damage caused by force majeure.
4. Failure to meet the performance faults listed in the Product Performance Fault Table.
5. Performance faults listed in the Product Performance Fault Table caused by human factors.

Name	Performance
X39R Series Button Switch	1. The product fails to power on after being connected to electricity.
	2. The status indicator light is ineffective.
	3. The device cannot be configured to the network.
	4. Other hardware failures prevent the product from functioning properly.

Note: The product, accessories, and user interface illustrations in this manual are for reference only. Due to product updates and upgrades, the actual product may differ slightly from the illustrations. Please refer to the physical product for accuracy.

## Contact Information



Ledgebit Technologies Private Limited,  
401, Vipul Trade Center, Sec 48,  
Gurugram, Haryana 122018



[www.ledgebit.com](http://www.ledgebit.com)



[sales@ledgebit.com](mailto:sales@ledgebit.com)



+91-9810320256